

we
are
arco

we
make
tables

arco

product
**Shift
(extendable)**

designer
Jorre van Ast

Year
2019

Assembly
instructions

Please follow step 1 - 11

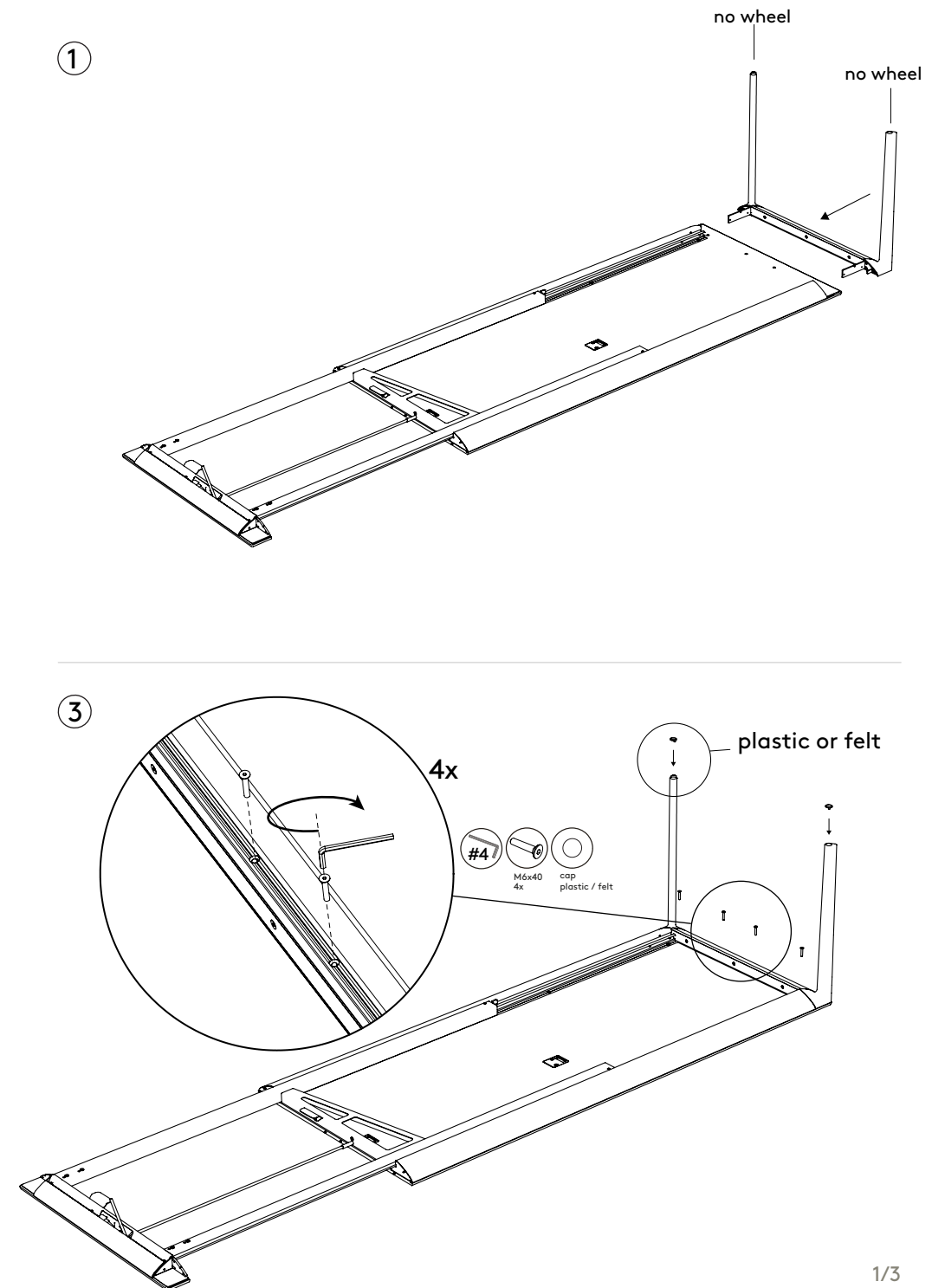
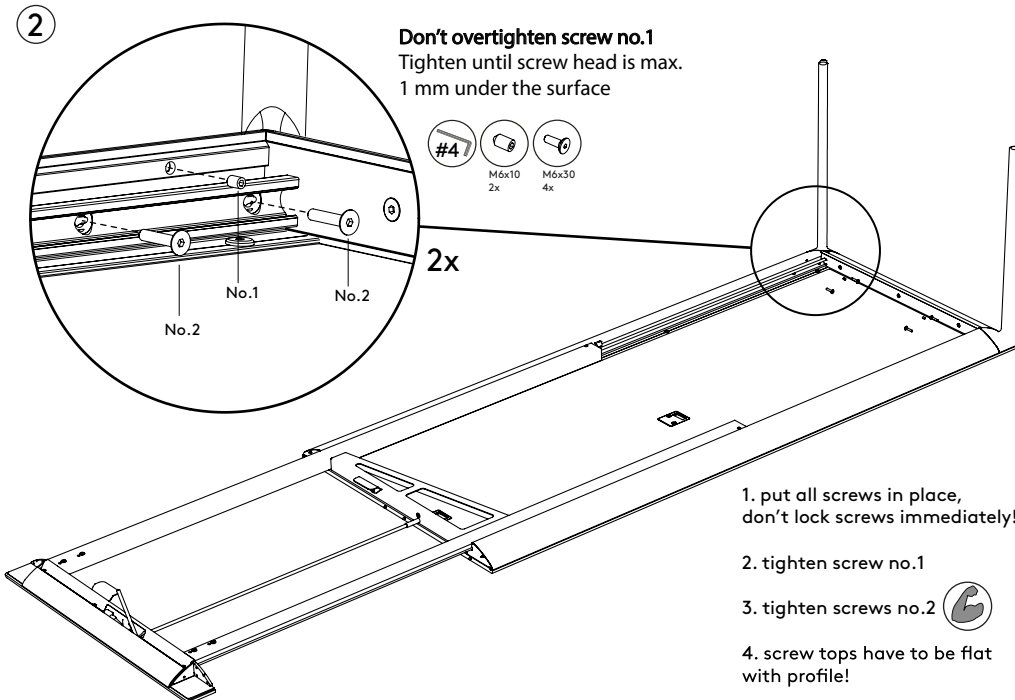
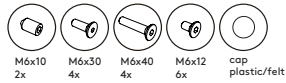

④

Pay attention to
wheel direction!

perpendicular to
table length

parrallel to
table length

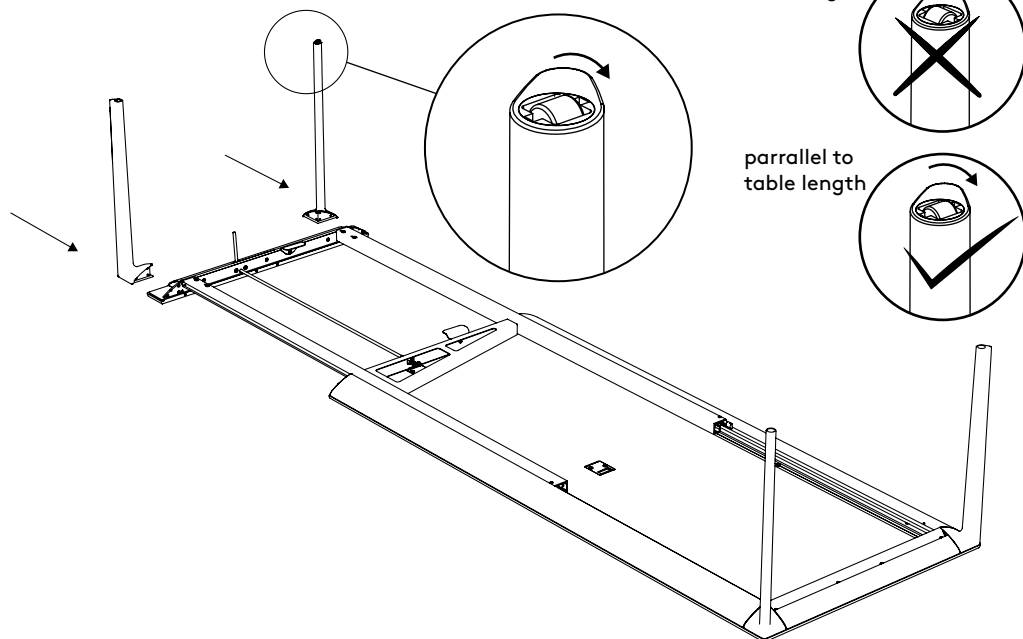

⑤

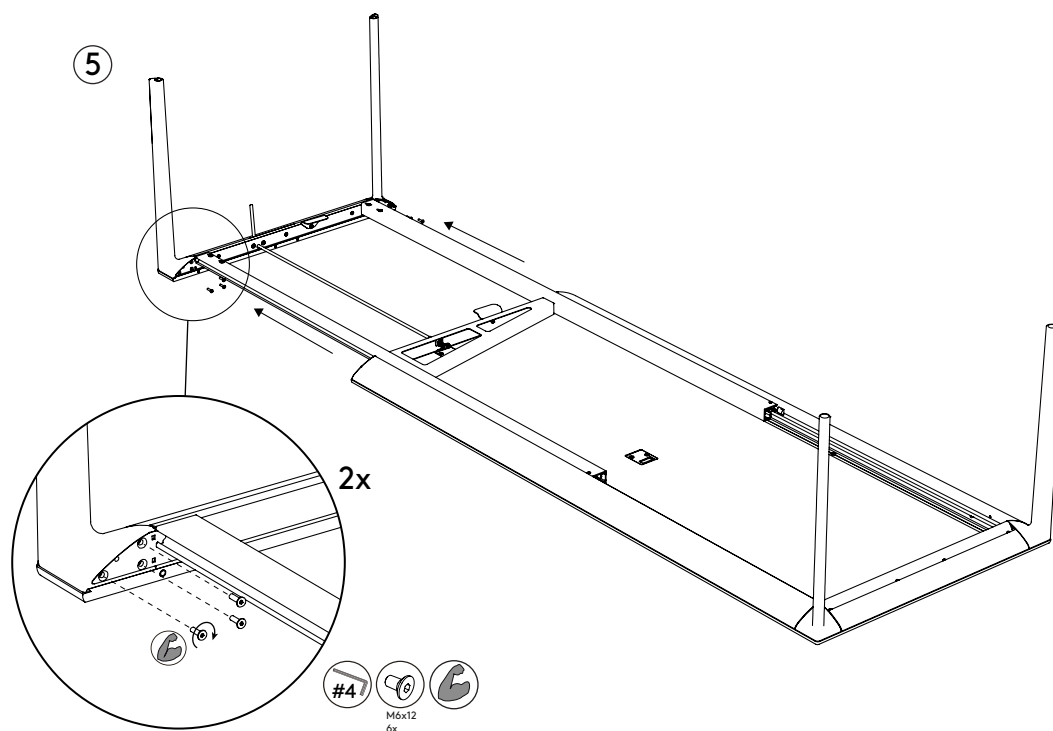

⑥

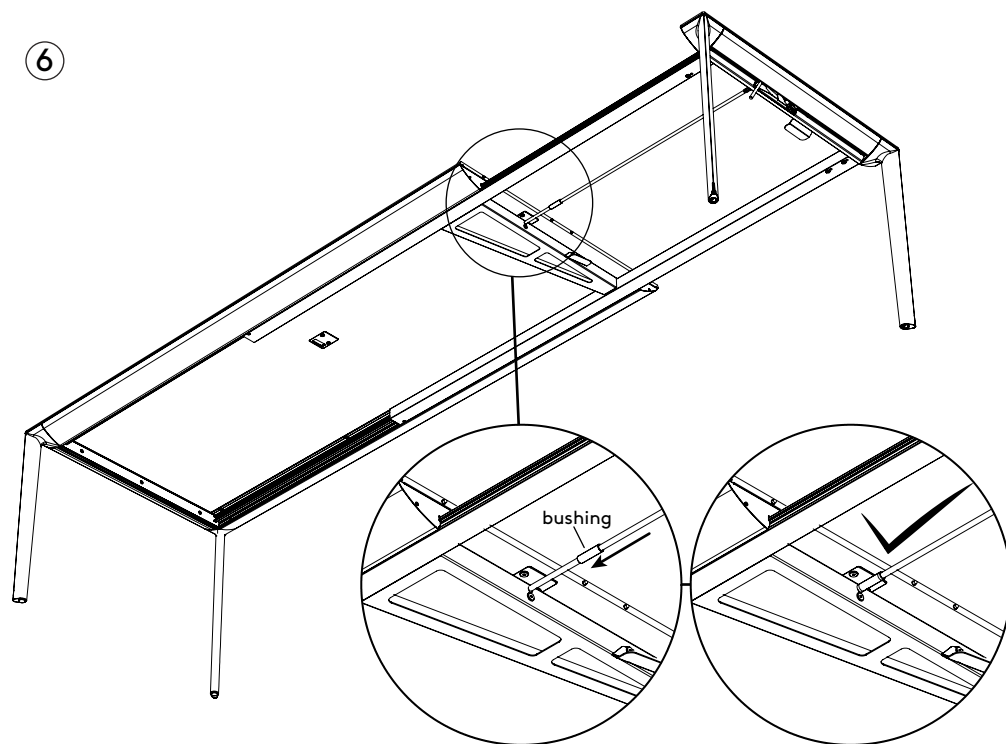

⑦

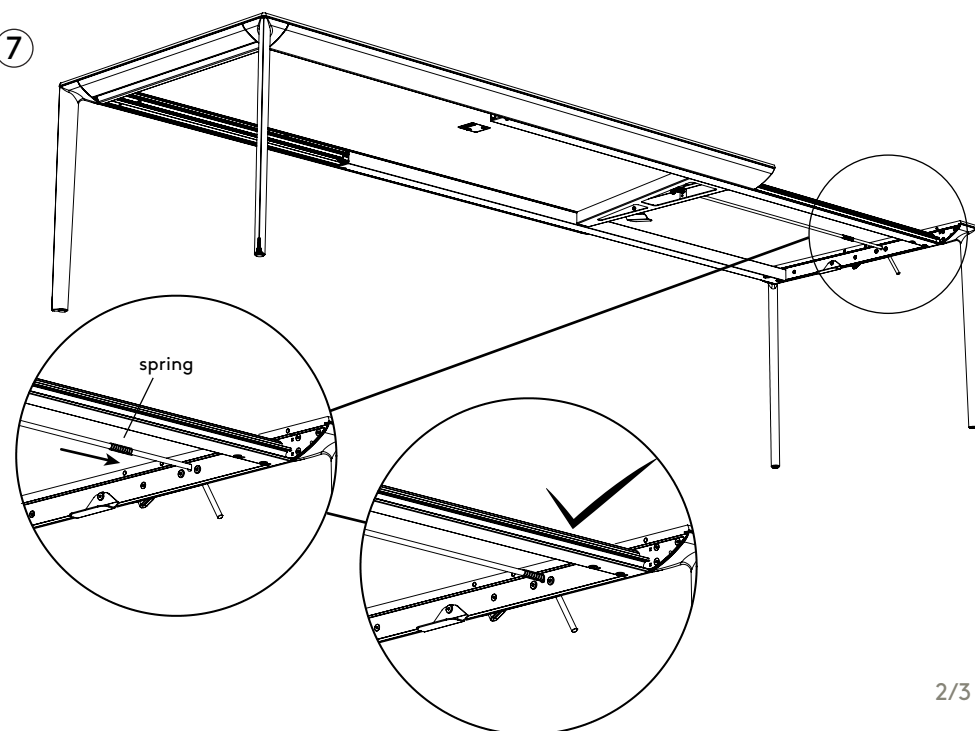

- ⑧ Place extension leaf between the spring and bushing

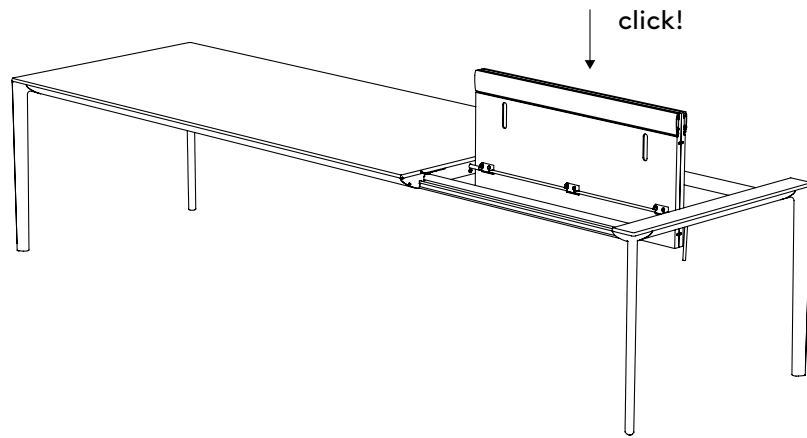

⑨

unfold extension leaf

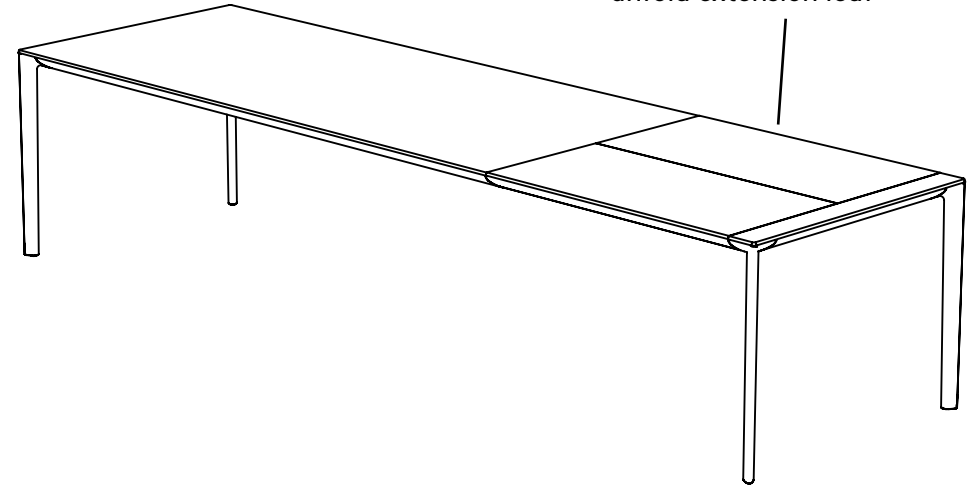

⑩

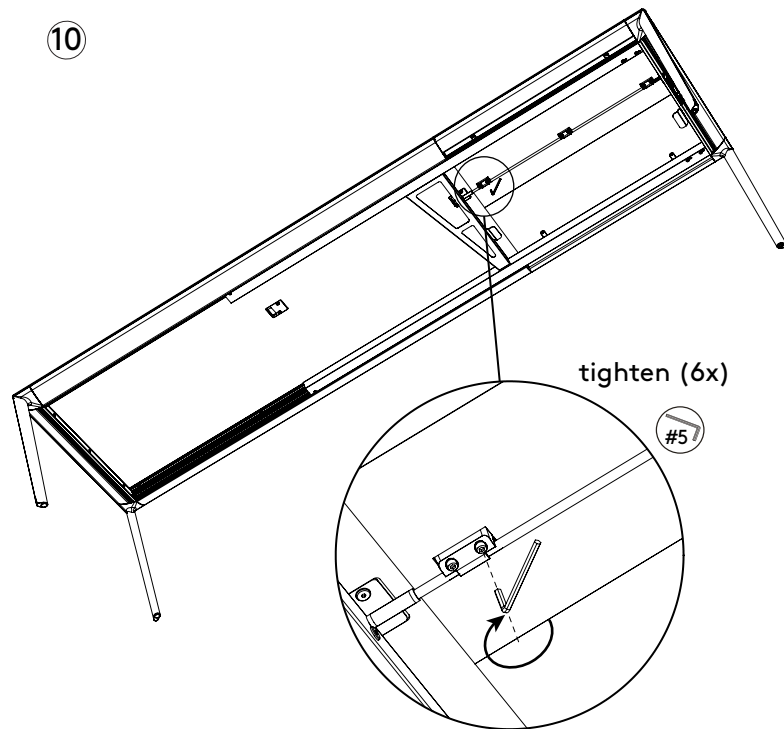

⑪

see attached manual for
operating instructions

