

1 **Cast**

**Jorre  
van Ast**

2019

2a **Standard**

Cast rectangular 1 (thickened 2x20 mm)

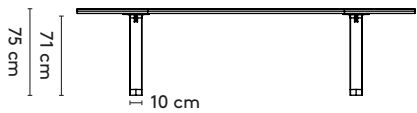

- 210 x 95 x 75 cm (between legs: 140 cm)
- 240 x 100 x 75 cm (between legs: 170 cm)
- 280 x 100 x 75 cm (between legs: 190 cm)
- 320 x 105 x 75 cm (between legs: 210 cm)
- 360 x 105 x 75 cm (between legs: 230 cm)

Cast rectangular 2 (solid)

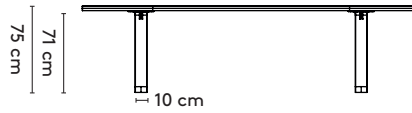
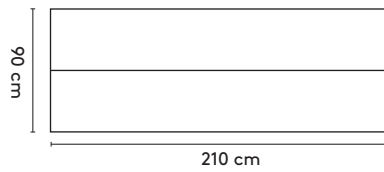

- 210 x 95 x 75 cm (between legs: 150/130/110cm)
- 240 x 100 x 75 cm (between legs: 180/160/140cm)
- 280 x 100 x 75 cm (between legs: 220/200/180cm)
- 320 x 105 x 75 cm (between legs: 260/240/220cm)
- 360 x 105 x 75 cm (between legs: 230cm)

Cast rectangular 2 connected

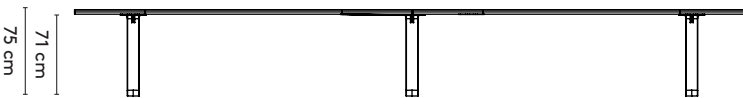
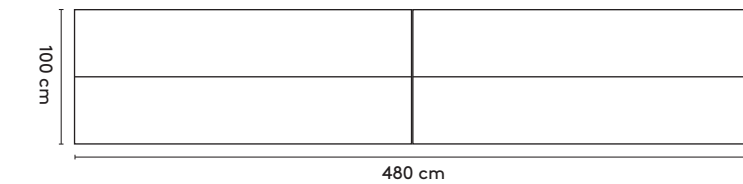

- 480 x 100 x 75 cm (between legs: 195/185/175 cm)
- 560 x 100 x 75 cm (between legs: 235/225/215 cm)

2b **Tailoring**

Cast rectangular 1 (thickened 2x20 mm)



Cast rectangular 2 (solid)

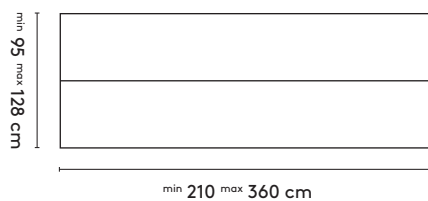

Cast rectangular 2 connected

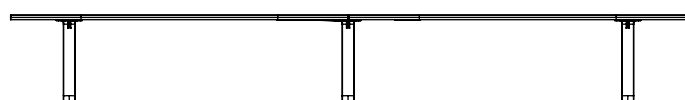
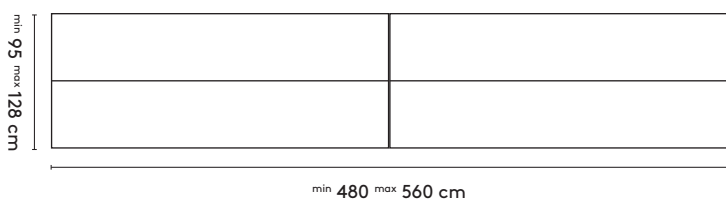

product

designer

year

# 1 Cast

# Jorre van Ast

# 2019

<b>3</b>	<b><u>Materials</u></b> Top: oak (solid, local wood) or walnut (solid), oak smoked (solid) Legs: epoxy fine texture on aluminum	<b><u>Materialen</u></b> Blad: eiken (massief, lokaal hout) of noten (massief), eiken gerookt (massief) Onderstel: epoxy fine texture op aluminium	<b><u>Materialien</u></b> Platte: Eiche (Massiv, lokales Holz) oder Nussbaum (Massiv), Eiche geräuchert (Massiv) Untergestell: Epoxy fine texture auf Aluminium
<b>4</b>	<b><u>Finishes</u></b> All Arco colors and finishes for the mentioned materials	<b><u>Afwerkingen</u></b> Alle Arco kleuren en (lak)afwerkingen voor de genoemde materialen	<b><u>Ausführungen</u></b> Alle Arco Farben und Ausführungen für die genannten Materialien
<b>5</b>	<b><u>Additional information</u></b> Legs can be mounted at 25, 35 or 45 cm from the short side of the table (solid top only)	<b><u>Aanvullende informatie</u></b> Onderstel kan worden gemonteerd op 25, 35 of 45 cm van de korte zijde van de tafel (alleen met massief blad)	<b><u>Weitere Informationen</u></b> Untergestell kann auf 25, 35 und 45 cm der kurze Seite des Tisches montiert werden (nur mit Massive platte)

## 6 Cable management

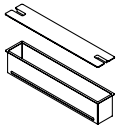

CM06/CM07  
epoxy  
30/50 cm



CM15  
EVOLine® One spot  
Ø 5,9 cm

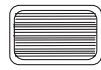

CM08/CM09  
cable-net  
small/large



CM12  
cable sock  
large



CM13  
zipper sock  
short